

VARIANCE[®] P

GLASS CLADDING SYSTEM



We Build the Invisible

Member of
**SIMONSWERK
GROUP**



PATENTED 

Installation
on all types of
buildings (new
or renovated)

VARIANCE® P

VARIANCE® P is a **patented wall cladding system** utilizing glass panels (as well as composite and concrete panels BEFUP) that is compatible with simple or complex building facades.

Its hook system **brings an easy fitting and saves significant time.**

A pre-assembly in the workshop optimizes the logistics and the handling of cladding elements.

The **Single Hook technology** extends its field of application to **double skins and interior and exterior facades.**

VARIANCE P is compatible with any kind of **geometry, symmetrical or asymmetrical**, horizontal or vertical grids and various types of support and framing, including wood frames.

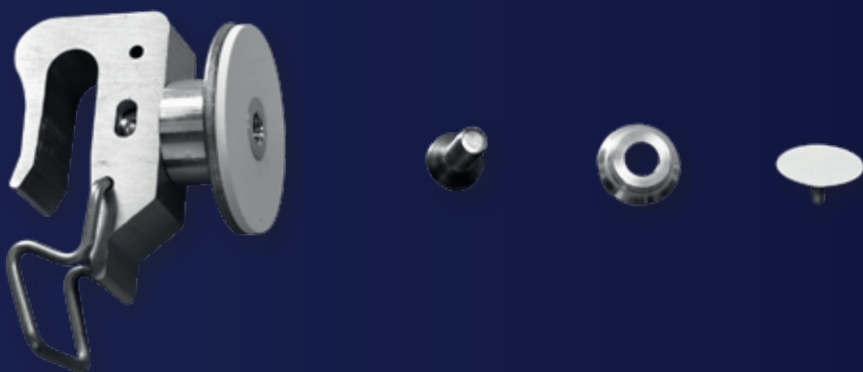

MAIN ADVANTAGES OF OUR GLASS CLADDING SYSTEM

- 1 heat retention in the building during winter and insulation in case of high outside temperatures;
- 2 it considerably reduces thermal bridges and waterproofing problems;
- 3 a longer life of the facade since it protects the building from bad weather;
- 4 in case of renovation, our system allows you to keep the surface of the SHON (net floor area);
- 5 the fixing by hooks does not imply no gluing or drying time;
- 6 easy maintenance in case of replacement of a cladding.

Installation on rails

All types of structures
Not provided by SADEV



Horizontal secondary structure
Specific profile called «rail»

Different types of structures are possible:
aluminum rail, wood.....



Hanging the panels on the rails





INSTALLATION ADVANTAGES

MOUNTING OF FIXTURES **ON GLASS IN MASKED TIME**

(Site / workshop)

PALONIER ONLY **FOR GLASS HANGING**

OPTIMIZATION OF THE TIME OF **CRANING**

AUTOMATIC GLASS SECURING

Its system of hooks brings a simplicity of installation and a considerable saving of time.

The **Hook technology** extends its field of application to **double skins and interior and exterior facades**.



Insert the ring and the screw in the milled hole of the panel and screw them with the hook.



Insert the capsule.



Hang your glass panels on the rails.

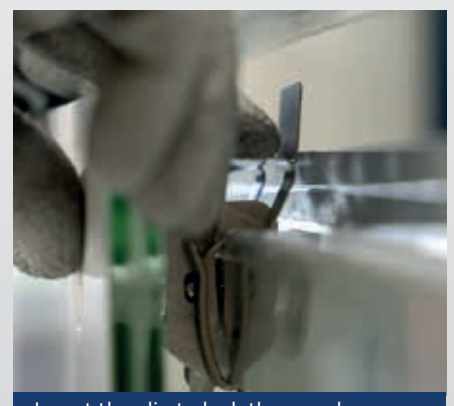

Insert the clip to lock the panel horizontally.

HOOK WEIGHT with anti-lift clip

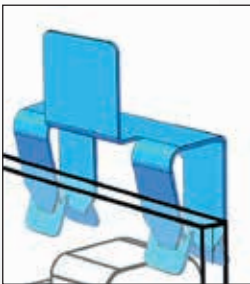

The anti-translation device

(seismic zone, negative slope, extreme wind pressure...)

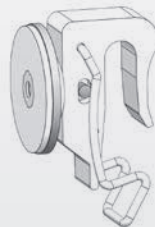
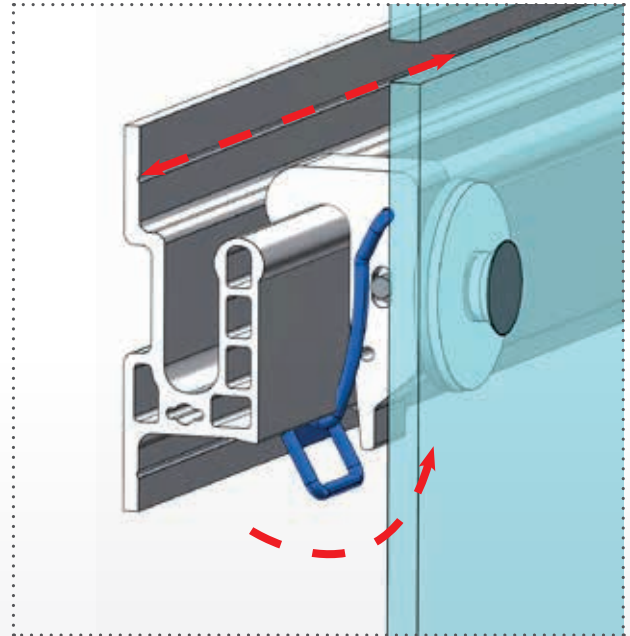

▪ **THE WEIGHT HOOKS** are load-bearing (weight-bearing). They are hooked on the top rail and also guarantee the anti-lift functionality.



▪ **THE WIND HOOKS** are points that hold the panel in pressure/depression under the effect of the wind.

WIND HOOK « free point » with anti-noise solution to avoid any noise pollution.



A system that avoids stresses into the glass!

• THE EXPANSION POINT

This hook allows a horizontal movement.

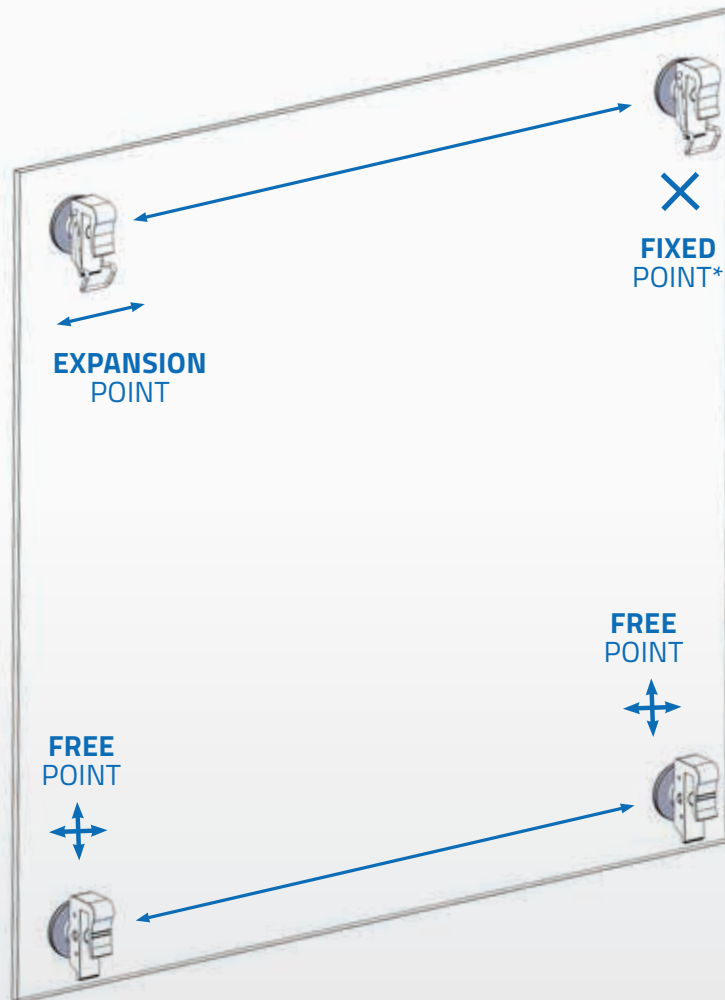

• THE FIXED POINT

This point is completely locked, preventing any movement. In this case, it is the fixed reference point.

* The fixed point can be positioned on right or left side depending on the steering installation.

• THE FREE POINTS

The hooks are longer to allow easy support and hooking during installation.

A vertical positioning gap between the rail and the hook enables for both horizontal and vertical translation of the panel (expansion).



TECHNICAL ADVANTAGES

UNIQUE ADAPTABLE
FIXING SYSTEM.

MINIMALIST
HANGING SYSTEM.

LOAD DISTRIBUTION
BETWEEN ALL FASTENERS.

IMPACT RESISTANCES
(UP TO Q4 LEVEL).

COMPATIBLE

Laminated glasses / monolithic glasses





ENVIRONMENTAL ADVANTAGES

- | PRODUCT LIFE CYCLE ANALYSIS **100% RECYCLABLE** SYSTEM MADE FROM **RECYCLED PRODUCTS**.
- | ENVIRONMENTAL AND SANITARY DECLARATION SHEET (FDES).
- | **IDEAL FOR PHOTOVOLTAIC FACADE** (WITH OR WITHOUT INCLINATION).
- | THERMAL AND **SOUND INSULATION CAPACITY** (DEPENDING ON THE CHOSEN INSULATION).
- | RT2012/RE2020: **PERFECT FOR EXTERIOR INSULATION IN RENOVATION PROJECTS**.

The glass panels can have different dimensions on the same façade.



Disappearance of the fixing



ARCHITECTURAL ADVANTAGES

FITS ALL SHAPES AND INCLINATIONS OF WALLS, FROM VERTICAL TO OVERHANGS AND CEILING RETURN.

USE OF A MULTITUDE OF CLADDINGS ON THE SAME FRAME.

Give volume to the facades

3D facade possible
glass scale

Our system
makes it possible
to create any type
of facade whether
it's standard
or unique

Example of colours available from our glass partners

Rglass email - VIP 51



Rglass email - VIP 62



SGG Emalit Evolution - Black

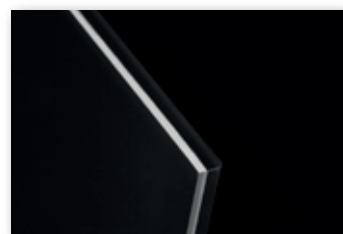



ARCHITECTURAL ADVANTAGES

REMOVAL OF FIXINGS.

MONOLITHIC TEMPERED GLASS /
LAMINATED TEMPERED GLASS /
PHOTOVOLTAIC SOLAR PANELS.

INSTALLATION ON NEW
CONSTRUCTION OR RENOVATION.

WIDE CHOICE OF COLORS,
DESIGNS AND PRINTS.

SGG Emalit Evolution - Blue Grey



AGC Lacobel T - Petrol green

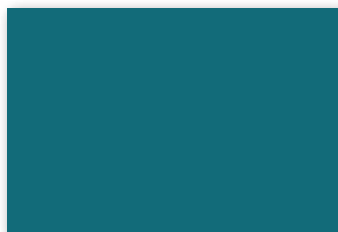

AGC Lacobel T - Zen grey



Dimensioning - Laminated glass **4 fixings**

6.6 PVB

8.8 PVB

10.10 PVB

		Pressure on the facade element at ELS [Pa]								
Height [m]	Width [m]	Glass thickness [mm]								
		400	500	600	700	800	900	1000	1100	1261
1	0,8	[Pressure values represented by a color gradient from light blue to dark blue]								
	1									
	1,2									
	1,4									
	1,6									
	1,8									
1,2	0,8	[Pressure values represented by a color gradient from light blue to dark blue]								
	1									
	1,2									
	1,4									
	1,6									
	1,8									
1,4	0,8	[Pressure values represented by a color gradient from light blue to dark blue]								
	1									
	1,2									
	1,4									
	1,6									
	1,8									
1,6	0,8	[Pressure values represented by a color gradient from light blue to dark blue]								
	1									
	1,2									
	1,4									
	1,6									
	1,8									

Possible dimensions: 2,80 x 3,60 meters

6.6 PVB

8.8 PVB

10.10 PVB

Pressure on the facade element at ELS [Pa]

Height [m]	Width [m]	Glass thickness [mm]								
		400	500	600	700	800	900	1000	1100	1261
1,8	0,8	[Color-coded pressure values]								
	1									
	1,2									
	1,4									
	1,6									
	1,8									
2	0,8	[Color-coded pressure values]								
	1									
	1,2									
	1,4									
	1,6									
	1,8									
2,2	0,8	[Color-coded pressure values]								
	1									
	1,2									
	1,4									
	1,6									
	1,8									

MAXIMUM ALLOWABLE PRESSURE (at ELS)

		Width [m]					
		0,8	1	1,2	1,4	1,6	1,8
Height [m]	1	5582	5031	3683	2796	2176	1644
	1,2	3976	3683	3382	2610	2069	1571
	1,4	2953	2796	2610	2428	1944	1487
	1,6	2262	2176	2069	1944	1827	1403
	1,8	1672	1644	1571	1487	1403	1328
	2	1204	1193	1159	1111	1054	1001
	2,2	895	889	877	846	813	774

Glass thickness: 8.8 PVB

Dimensioning - Laminated glass **6 fixings**

6.6 PVB

8.8 PVB

10.10 PVB

Pressure on the facade element at ELS [Pa]

Height [m]	Width [m]	Glass thickness [mm]								
		400	500	600	700	800	900	1000	1100	1261
1,6	1									
	1,2									
	1,4									
	1,6									
	1,8									
1,8	1									
	1,2									
	1,4									
	1,6									
	1,8									
2	1									
	1,2									
	1,4									
	1,6									
	1,8									
2,2	1									
	1,2									
	1,4									
	1,6									
	1,8									
2,4	1									
	1,2									
	1,4									
	1,6									
	1,8									
2,6	1									
	1,2									
	1,4									
	1,6									
	1,8									
2,8	1									
	1,2									
	1,4									
	1,6									
	1,8									

Possible dimensions: 2,80 x 3,60 meters

6.6 PVB

8.8 PVB

10.10 PVB

Pressure on the facade element at ELS [Pa]

Height [m]	Width [m]	Glass thickness [mm]								
		400	500	600	700	800	900	1000	1100	1261
3	1	[Color-coded pressure values]								
	1,2	[Color-coded pressure values]								
	1,4	[Color-coded pressure values]								
	1,6	[Color-coded pressure values]								
	1,8	[Color-coded pressure values]								
3,2	1	[Color-coded pressure values]								
	1,2	[Color-coded pressure values]								
	1,4	[Color-coded pressure values]								
	1,6	[Color-coded pressure values]								
	1,8	[Color-coded pressure values]								
3,4	1	[Color-coded pressure values]								
	1,2	[Color-coded pressure values]								
	1,4	[Color-coded pressure values]								
	1,6	[Color-coded pressure values]								
	1,8	[Color-coded pressure values]								
3,6	1	[Color-coded pressure values]								
	1,2	[Color-coded pressure values]								
	1,4	[Color-coded pressure values]								
	1,6	[Color-coded pressure values]								
	1,8	[Color-coded pressure values]								

MAXIMUM ALLOWABLE PRESSURE (at ELS)

		Width [m]				
		1	1,2	1,4	1,6	1,8
Height [m]	1,6	1958	1625	1358	1199	1043
	1,8	1655	1407	1210	1043	935
	2	1447	1253	1075	926	826
	2,2	1282	1096	972	850	737
	2,4	1143	982	869	766	690
	2,6	1034	889	779	710	626
	2,8	939	806	710	637	579
	3	855	740	652	582	536
	3,2	785	681	600	537	488
	3,4	726	630	554	499	451
	3,6	672	584	517	464	420

Glass thickness: 8.8 PVB

Dimensioning - **Monolithic glass** **4 fixings**

6 mm

8 mm

10 mm

		Pressure on the facade element at ELS [Pa]								
Height [m]	Width [m]	Glass thickness [mm]								
		400	500	600	700	800	900	1000	1100	1261
1	0,8	6 mm								
	1	6 mm								
	1,2	8 mm								
	1,4	8 mm								
	1,6	10 mm								
	1,8	10 mm								
1,2	0,8	6 mm								
	1	6 mm								
	1,2	8 mm								
	1,4	8 mm								
	1,6	10 mm								
	1,8	10 mm								
1,4	0,8	6 mm								
	1	6 mm								
	1,2	8 mm								
	1,4	8 mm								
	1,6	10 mm								
	1,8	10 mm								
1,6	0,8	6 mm								
	1	6 mm								
	1,2	8 mm								
	1,4	8 mm								
	1,6	10 mm								
	1,8	10 mm								

Possible dimensions: 2,80 x 3,60 meters

6 mm

8 mm

10 mm

Pressure on the facade element at ELS [Pa]

Height [m]	Width [m]	Glass thickness [mm]								
		400	500	600	700	800	900	1000	1100	1261
1,8	0,8	6	8	10	10	10	10	10	10	10
	1	6	8	10	10	10	10	10	10	10
	1,2	6	8	10	10	10	10	10	10	10
	1,4	6	8	10	10	10	10	10	10	10
	1,6	6	8	10	10	10	10	10	10	10
	1,8	6	8	10	10	10	10	10	10	10
2	0,8	6	8	10	10	10	10	10	10	10
	1	6	8	10	10	10	10	10	10	10
	1,2	6	8	10	10	10	10	10	10	10
	1,4	6	8	10	10	10	10	10	10	10
	1,6	6	8	10	10	10	10	10	10	10
	1,8	6	8	10	10	10	10	10	10	10
2,2	0,8	6	8	10	10	10	10	10	10	10
	1	6	8	10	10	10	10	10	10	10
	1,2	6	8	10	10	10	10	10	10	10
	1,4	6	8	10	10	10	10	10	10	10
	1,6	6	8	10	10	10	10	10	10	10
	1,8	6	8	10	10	10	10	10	10	10

MAXIMUM ALLOWABLE PRESSURE (at ELS)

Height [m]		Largeur [m]						
		0,8	1	1,2	1,4	1,6	1,8	
1	1	3714	3347	2450	1860	1261	892	
	1,2	2646	2450	2250	1723	1191	852	
	1,4	1965	1860	1723	1603	1114	807	
	1,6	1311	1261	1191	1114	1047	761	
	1,8	907	892	852	807	761	721	
	2	653	648	629	603	572	543	
	2,2	485	482	476	459	441	420	

Glass thickness: 10 mm

Dimensioning - Monolithic glass **6 fixings**

6 mm

8 mm

10 mm

Pressure on the façade element at ELS [Pa]

Height [m]	Width [m]	Glass thickness [mm]								
		400	500	600	700	800	900	1000	1100	1261
1,6	1	6	6	6	6	6	6	6	6	6
	1,2	6	6	6	6	6	6	6	6	6
	1,4	6	6	6	6	6	6	6	6	6
	1,6	6	6	6	6	6	6	6	6	6
	1,8	6	6	6	6	6	6	6	6	6
1,8	1	6	6	6	6	6	6	6	6	6
	1,2	6	6	6	6	6	6	6	6	6
	1,4	6	6	6	6	6	6	6	6	6
	1,6	6	6	6	6	6	6	6	6	6
	1,8	6	6	6	6	6	6	6	6	6
2	1	6	6	6	6	6	6	6	6	6
	1,2	6	6	6	6	6	6	6	6	6
	1,4	6	6	6	6	6	6	6	6	6
	1,6	6	6	6	6	6	6	6	6	6
	1,8	6	6	6	6	6	6	6	6	6
2,2	1	6	6	6	6	6	6	6	6	6
	1,2	6	6	6	6	6	6	6	6	6
	1,4	6	6	6	6	6	6	6	6	6
	1,6	6	6	6	6	6	6	6	6	6
	1,8	6	6	6	6	6	6	6	6	6
2,4	1	6	6	6	6	6	6	6	6	6
	1,2	6	6	6	6	6	6	6	6	6
	1,4	6	6	6	6	6	6	6	6	6
	1,6	6	6	6	6	6	6	6	6	6
	1,8	6	6	6	6	6	6	6	6	6
2,6	1	6	6	6	6	6	6	6	6	6
	1,2	6	6	6	6	6	6	6	6	6
	1,4	6	6	6	6	6	6	6	6	6
	1,6	6	6	6	6	6	6	6	6	6
	1,8	6	6	6	6	6	6	6	6	6
2,8	1	6	6	6	6	6	6	6	6	6
	1,2	6	6	6	6	6	6	6	6	6
	1,4	6	6	6	6	6	6	6	6	6
	1,6	6	6	6	6	6	6	6	6	6
	1,8	6	6	6	6	6	6	6	6	6

Possible dimensions: 2,80 x 3,60 meters

6 mm

8 mm

10 mm

Pressure on the façade element at ELS [Pa]

Height [m]	Width [m]	Glass thickness [mm]									
		400	500	600	700	800	900	1000	1100	1261	
3	1	■									
	1,2	■									
	1,4	■									
	1,6										
	1,8										
3,2	1	■									
	1,2	■									
	1,4	■									
	1,6										
	1,8										
3,4	1	■									
	1,2	■									
	1,4										
	1,6										
	1,8										
3,6	1	■									
	1,2										
	1,4										
	1,6										
	1,8										

MAXIMUM ALLOWABLE PRESSURE (at ELS)

Height [m]		Largeur [m]				
		1	1,2	1,4	1,6	1,8
Height [m]	1,6	1320	1095	915	808	703
	1,8	1115	948	816	703	630
	2	976	845	724	624	556
	2,2	864	739	655	573	497
	2,4	770	662	586	516	465
	2,6	697	599	525	478	422
	2,8	633	544	479	430	390
	3	577	499	440	393	361
	3,2	529	459	405	362	329
	3,4	490	425	374	336	304
	3,6	453	393	349	313	283

Glass thickness: 10 mm



We Build the Invisible

CLASSIC

DECOR

CONSTRUCT

SABCO

SWIMSIDE

Member of
**SIMONSWERK
GROUP**

Tél. +33(0) 4 50 08 39 00 | info@sadev.com
76, chemin des Poses - 74330 Poisy (France)

sadev.com
follow us on

